

Capabilities



interlake
 **MECALUX**



1

3

4

5

11

2

3

4

5

6

13

14

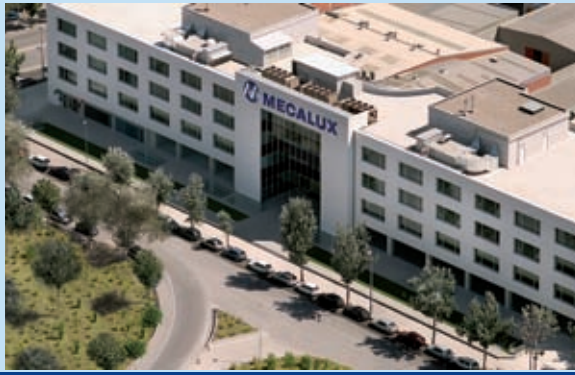

Mecalux is one of the leading companies in the logistics sector worldwide. We operate in 5 continents, more than 70 countries and we offer global storage solutions to small, medium and major businesses.

From the President

The development, expansion and improvement of the service that a company provides for its clients relies without question on knowing how to anticipate their needs and consequently, on being able to supply products that improve their work and fulfill their expectations. Thus, Mecalux clearly recognizes that new technologies play a key role in the development of our company and we devote much time and effort to them.

The experience and knowledge gained from more than forty years in the storage sector as well as the satisfaction of expanding and improving from day to day, have meant that today, Mecalux is one of the leading companies in the logistics sector worldwide. We operate in 5 continents, more than 70 countries and we offer global storage solutions to small, medium and major businesses.

We are working towards continued growth by investing a significant amount of our profits. The new factory plants in Poland and Chicago, the robotics department that develops automated storage systems and the logistics portal logismarket.com, are already well underway and have allowed us to supply our clients with a wide range of products and services.

I would like to express my thanks to all the clients, shareholders and more than 3,800 employees who have made it possible for Mecalux to move forward into a bright future.

José Luis Carrillo
Mecalux Group President



With more than 42 years of experience,
Mecalux is able to provide storage solutions for any available space



Chicago: 391,000 sq.ft.



Pontiac: 415,000 sq.ft.



Sumter: 250,000 sq.ft.



Middletown: 128,000 sq.ft.



Tijuana: 378,000 sq.ft.



Matamoros: 154,000 sq.ft.

Our six plants, totalling over 1.7 million square feet production surface, supply the United States from coast to coast. These plants are equipped with the most sophisticated technology for manufacturing storage racks and

shelving. Using prime quality steel, they have the capacity to produce over 1,750 tons per days.

Computerized tensile tests are conducted on all incoming steel coils to ensure adherence to required quality levels. The same high quality standard is applied to our painting processes. Frames are electro-statically immersed in epoxy paint and oven baked. This ensures that the paint

impregnates every surface, offering corrosion resistance that rivals galvanizing. Our beams receive two solid coats of enamel paint on every surface and are then oven baked.

Our in-house slitting capabilities provide us with high production flexibility, enabling us to meet the most demanding lead times. Our plants also carry significant inventory in stock to meet your delivery requirements.



State-of-the-art technology is also used at the initial stages of product research and development

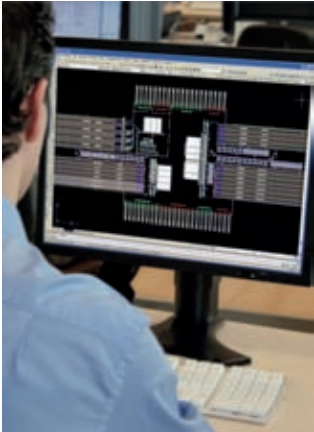

Using highly engineered calculation systems (ANSYS software), every part is tested for its response to different load situations, both as an individual component and as an integral part of a system. Thanks to this research we can offer you a product that optimizes the usage of steel and provides increased load resistance and security. By eliminating waste we can also offer you more competitive prices.

Highly sophisticated software is employed to evaluate different layouts and determine the most optimal distribution of our systems in your warehouse. This software also helps us integrate columns, girders, and any other architectural obstructions. Making the most of the space available enables us to offer you a very competitive price per pallet position.

Our practices and standards in regards to product design and manufacturing have earned us several certifications worldwide, such as the Rack Manufacturers Institute (RMI) certification and the ultimate warranty for compliance with US quality and safety standards, both in seismic and non-seismic environments.

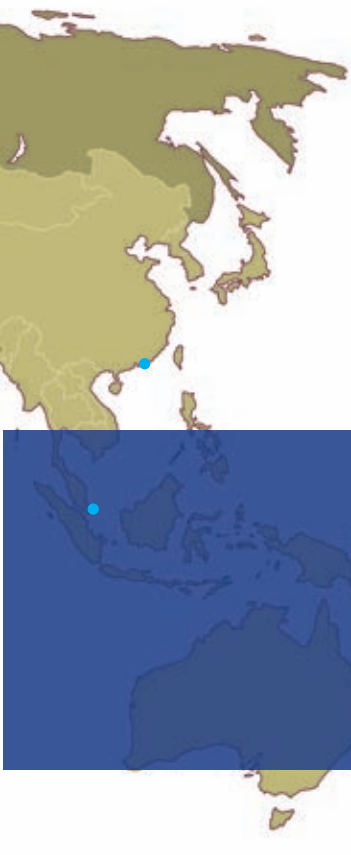
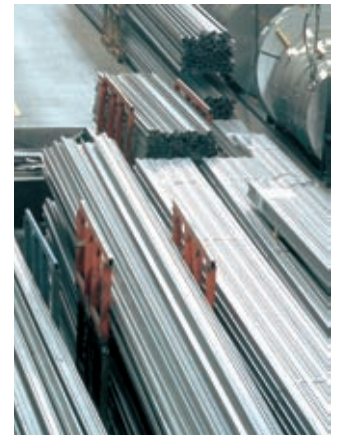

- Factories
- Sales Offices
- Distributors

Interlake Mecalux constantly strives to offer you the very best. Our intelligent storage solutions combine quality, service and price. We also offer you a vast experience of over 42 years resolving specific problems and the solid financial foundation of the Mecalux Group, present in more than 70 countries world-wide and employing over 3,800 people.

Markets and Channels to Market

The primary markets served by Interlake Mecalux products and services include companies which operate full-scale distribution centers, warehouses of all sizes, manufacturing facilities, and archive and record storage environments. Products and services are delivered to end users both directly from Interlake Mecalux and via a wide and proficient network of certified material handling distributors and catalog partners; who have made it possible for Interlake Mecalux to move forward into a bright future.



Products

Interlake Mecalux offers all types of pallet racks –roll formed and structural steel construction–welded and bolted frames–including: Selective Racks, Push Back Racks, Drive-In/Drive-Thru Racks, Cantilever Racks, Light Duty Shelving, Carton Flow systems and Pallet Flow products.

Key Services

Facility Design

We provide strategic planning, data analysis, concept development and evaluation, computer simulation modeling, material handling design, equipment specifications, operational audits/ improvements, material handling system design and build, system controls/ integration specialists, and industrial engineers specializing in productivity/ space utilization /and material flow.

Automation and controls Engineering

Interlake Mecalux Automation and Services Group (ASG) is an industrial control system integrator providing a number of engineering and software services for a wide variety of plant floor automation applications. ASG offers a full service electrical installation department, a UL certified panel shop and has 20 plus years of experience with high speed sortation, custom built machines, and conveyor systems. ASG specializes in spare parts and replacement parts for conveyors and also carries a full line of conveyor replacement parts and can assist in identifying needed conveyor parts.



Interlake Mecalux is the largest manufacturer of storage racks in the Americas. The primary markets served by our offerings include companies which operate full-scale distribution centers, warehouses of all sizes, manufacturing facilities, and archive and record storage environments. Products and services are delivered to end users via a wide network of certified material handling distributors, catalog partners and directly. Our breadth of quality products, and reputation for timely delivery and accurate execution have made us the premier supplier of innovative storage systems in the material handling industry.



Assembly and Installation

Interlake Mecalux Installation Services team provides coordination of installation for all types of racking systems and related material handling components. The IS team is proficient at handling everything from the most basic storage racks systems to complex integrated material handling projects that incorporate racking, conveyance, sortation, controls, mezzanines, multi-level pick modules, rack supported buildings and more. Our turnkey offerings also include the option for site and/or project management to insure that your unique installation is completed safely to specifications, on schedule, and on budget.



Site and Project Management

Our experienced team of site supervisors and project managers take the worry and guess work out of material handling projects. From simple rack systems to complex pick modules and other integrated material handling systems, our site and project management team takes care of all the details and day to day management to ensure that your project finishes safely on time, on budget and operates just the way that it was designed to work.



Archive and Record Storage

The Archive Group develops engineered record storage solutions. Key services offered include efficiently laying out facilities, securing permits, and installing shelves, lighting and sprinklers - a complete turn-key solution. As a part of Interlake Mecalux, the largest rack manufacturer in the U.S., the Archive Group has the resources to handle any job.

Selective Pallet Rack

The optimal solution for warehouses with palletized products, our Selective Pallet Rack provides efficient use of space and immediate access to every load stored.



Often copied but never duplicated, roll formed selective pallet rack is the most popular and versatile pallet rack in the industry, providing efficient use of space and immediate access to every load stored.

- Selective rack systems are available with bolted and welded frames.
- Patented beam to frame connection creates the most rigid and reliable structure available.
- Easy one-step beam installation requires no special tools or training.

- Beam and column locking system provides exceptional protection against damage, tampering, and accidental disengagement.
- Durable powder coating and baked enamel finishes ensure long life even under the most demanding conditions.
- All welding is performed by American Welding Society (AWS) certified personnel.
- We offer a complete line of accessories to solve all of your rack requirements.

Drive-In/Drive-Thru Pallet Rack

Based on the "storage by accumulation" principle, Drive-In/Drive-Thru Pallet Rack is ideally suited to operations where a large quantity of relatively few SKU's are stored.

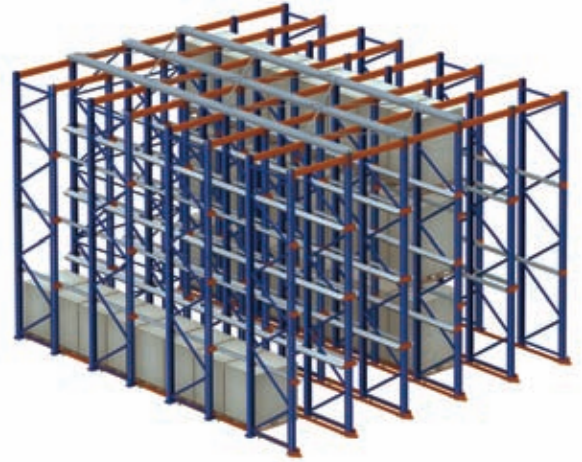

Because our Drive-In/Drive-Thru Rack requires fewer aisles, you can store up to 75% more pallets than with conventional pallet racks. Forklifts can drive directly into the rack to allow storage of six or more pallets deep.

- Provides the highest density storage solution available; the ideal solution for large volume storage of like product.

- Drive-In Rack uses a common entry/exit, while Drive-Thru rack has a separate entry and exit.
- Allows use of either roll formed or structural components with many arm and rail combinations.
- Reduces space costs; holds more loads.
- Designed for functionality, aesthetics and long life.



Conventional distribution

Total surface area for storage: 9.235,7 ft².
Capacity: 306 pallets per level

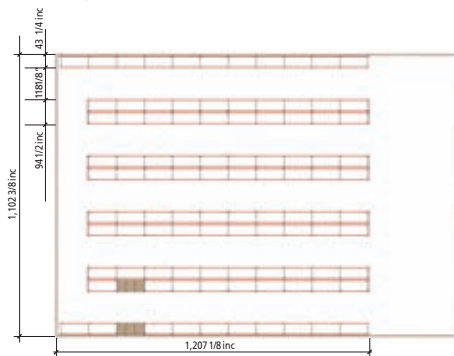

Drive-in distribution

Total surface area for storage: 9.203,4 ft².
Capacity: 522 pallets per level

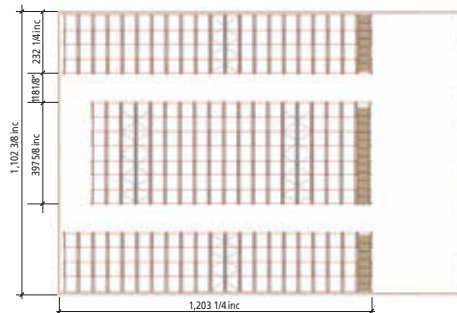

Carton Flow, Pallet Flow and Push-Back

Whether utilizing the first-in/first-out capability of Carton Flow and Pallet Flow or the first-in/last-out capability of Push Back Rack, these dynamic storage systems ensure the faces on each picking aisle remain stocked.



Using gravity as the free power source, our Selecta-Flo system cuts order picking labor costs up to 75% over static systems. Separate stoker and picker aisles with picking faces that are always stocked enhance efficiency, while our exclusive clipless track and guide system speeds assembly and reconfiguration.

- Greater cube utilization.
- Easy to reprofile.
- Stand-alone or easily integrated with other material handling systems.
- Organize fast and slow movers for maximum efficiency.



Pallet Flow storage can double or triple capacity compared to drive-in or conventional pallet rack systems. This alternative is ideal for freezer warehouses, food distribution centers, and storage of high-volume consumer goods.

- Maximize floor space – fewer aisles.
- Ideal for expiration date sensitive inventory.
- Durable construction for years of maintenance-free operation.



Our versatile Push-Back Rack uses telescoping carriages to store pallets up to five deep, providing multiple pick facing with extremely high throughput. Pallets are fed and retrieved from one aisle, reducing picking times and making these

racks ideal for applications that require a large number of picking faces.

- Provides optimal combination of selectivity and storage density.
- Debris-free design makes these racks perfect for food applications.

Structural Rack

Made from high resistant, hot rolled structural steel, and designed for higher capacity applications, Structural Rack can be used in multiple configurations including Selective Pallet, Drive-In and Push-Back.

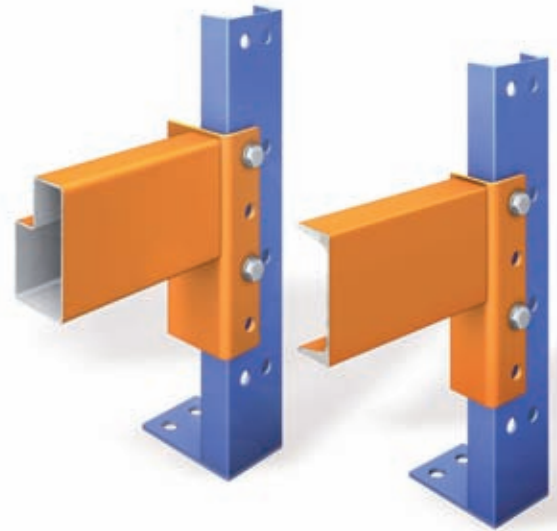

- Structural steel components can be used in multiple configurations including selective pallet, drive-in, Push-Back and more.
- They can be integrated with roll form components to provide a more economical alternative where a structural system is required.

Frames

- Structural steel with holes punched on 4" centers to attach the beams.
- Equipped with "U" brackets welded inside the channel to attach diagonals/horizontals.
- Footplate welded to the bottom of the post available in standard or seismic.



Typical bay opening

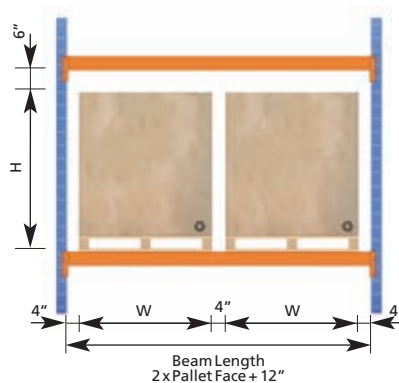

Typical back-to-back rack row configuration

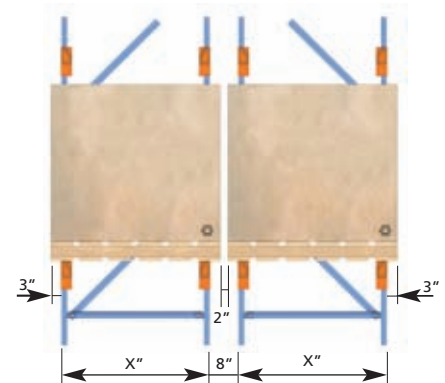

Cantilever Rack

With no aisle uprights to limit the use of horizontal space, Cantilever Rack offers a practical solution to store long or bulky items, such as metal beams, pipes, lumber and more.

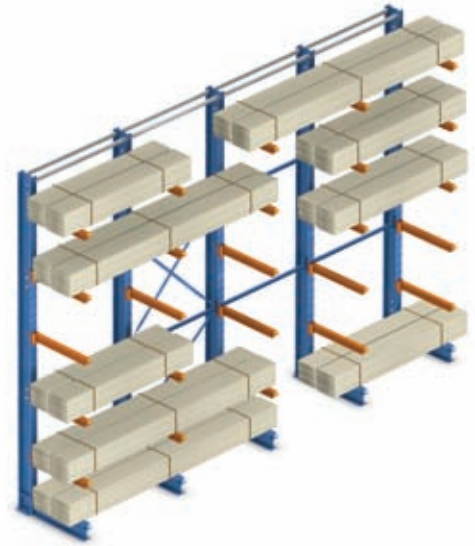

Available in roll formed and structural steel designs, with no aisle uprights to obstruct the use of horizontal space, our Cantilever Rack is ideal for storing longer, bulky items like carpet rolls, furniture, lumber, tubing, tires, textiles, piping, and similar items. Patented adjustable Lok-Joint pin-locks for the roll-formed cantilever racks are strong, safe, and allow easy height adjustment—making our arm-locking systems the best in the industry.

- Arms are adjustable on 4-inch centers - easy to re-profile
- Accessories such as drop-in decks and spring loaded entry guides enhance safety and protection.



Mezzanines

Installing a Mezzanine optimizes the full potential of warehouse space by doubling or tripling available storage areas and saving the cost of a conventional building expansion.

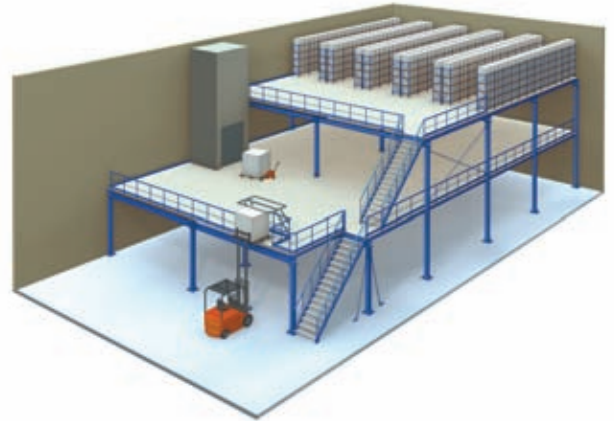

- They can be completely disassembled; all parts can be reused, and their structure, size or location can easily be modified.
- The wide range of sizes, floor types and construction systems mean the mezzanines can be adapted to meet specific client needs.
- They can be complimented with a variety of shelving systems.
- Platform and product lifts can also be incorporated to facilitate the movement of product from one level to another.
- They are quick, clean and easy to install.

Wide Span and Quick Assembly Shelving

Designed for storage areas in which goods are handled manually, Wide Span and Quick Assembly Rack assembles and re-configures quickly for fast, flexible storage of hand-loaded items.



Strong and easy to assemble, Q.A. and Wide Span Rack provide years of dependable, economic hand storage even if your requirements change frequently. It reconfigures quickly for fast and flexible storage of odd-sized, hand loaded items. With Q.A./Wide Span Rack, it's easy to organize parts and other small products for quick access.

- Lowers labor cost and facilitates quick changes.

- Drop-in shelf supports reduce beam quantity, accommodate a variety of product sizes, arrangements and steel, wood or particle board decking.
- Welded pre-fabricated frame ensures a strong, safe rack structure and long life span.
- Safety load lock ensures connection and prevents disengagement of beams.



Boltless Shelving

Used for light to medium hand-stacked applications, Boltless Shelving can be easily adapted to solve any storage need in a warehouse, office or retail establishment.



- The light gray post and beams make this system appropriate for both the office and the warehouse.
- It can be used for a variety of applications from archiving office records to storing totes, bins or boxes.
- We offer a 2.5" high beam for heavier applications. The longer beams are designed to accept our center cross ties for additional support.
- Our 1" low profile beam comes standard with a 2-prong connector that is more rigid than the traditional single rivet beam connectors.



Warehouse Management Software

Aimed at businesses of all sizes, EasyWMS can be used in any warehouse function; from a small company with a conventional warehouse to the logistics control of an airport.

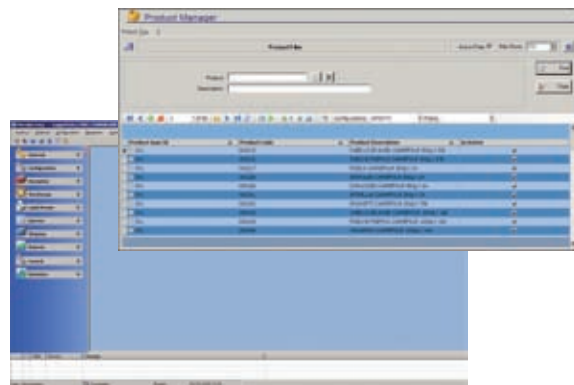
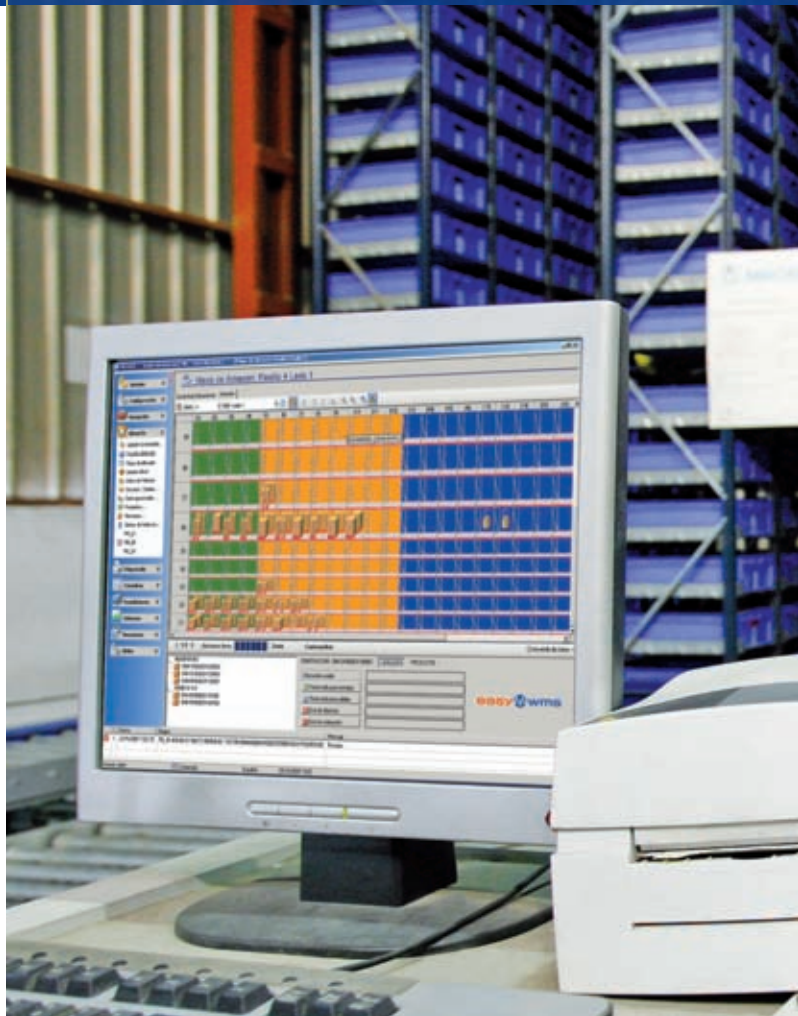

Functions of Software

In designing the software, Mecalux considered the necessity for a practical operating system in areas of high productivity.

As a result, the main functions of the software, the arrangement of the screens, the presentation of information and interaction with the operator creates a user-friendly and functional program.

With EasyWMS the following functions are simple to find and utilize:

- Product management
- Entry management
- Exit management
- Consultations and information
- Compatibility



Automated Warehouse for Pallets

Designed for the automated storage of pallets, Automated Warehouses for Pallets utilize stacker cranes to enter the aisles of the warehouse, position and extract materials.

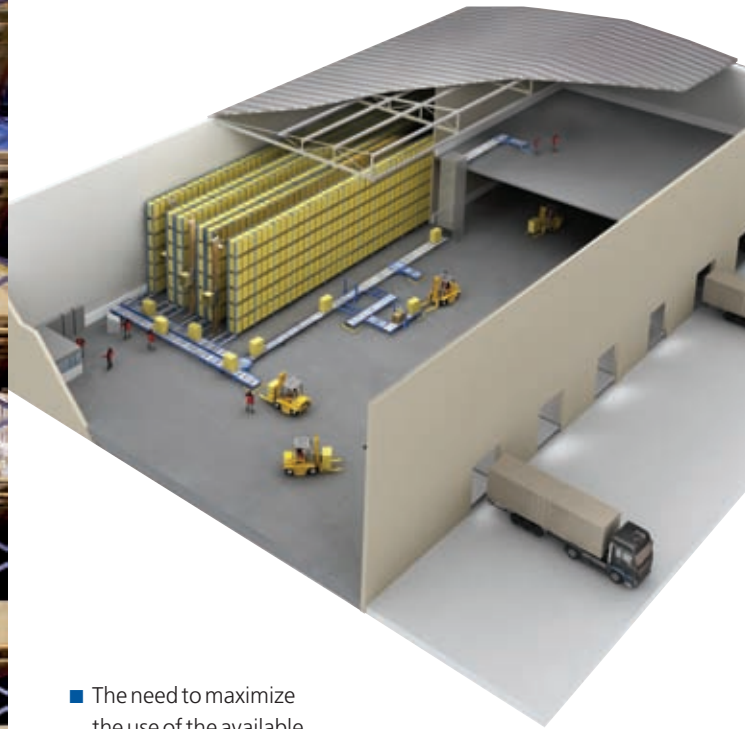

- The need to maximize the use of the available area of warehouses has led to the development of stacker cranes. These machines are designed to work in narrower aisles and at heights of more than 98 feet.
- Their speed of movement, both horizontally and vertically, along with their automated operation, enable handling capacity and pallet extraction to be increased threefold.
- The stacker cranes are guided by a software management system that coordinates every movement of the warehouse.
- Their efficiency eliminates any possible errors arising from manual operation.
- They allow the user to control and update warehouse management.

Miniload Warehouse

The optimum system for handling boxes for picking, the Miniload warehouse has an extraordinary capacity to adapt and be integrated into any production or storage process.



- Automated warehouses for boxes: the application of the "product to man" principle.
- Total automation.
- Permanent inventory.
- Optimal use of available space.
- Maximum comfort and easy access to the stored boxes.

The Vertical Group

Clasimat Vertical Lift Module (VLM)

Using the "product to man" principle, the Clasimat Vertical Lift Module automates product entry and exit with a shuttle elevator and extractor mechanism.



Advantages

- Provides computer managed warehouse.
- Saves space by utilizing the total height of the warehouse.
- Saves time by allowing the worker to minimize movement during order preparation.
- Increases safety of products during storage.

Applications

- The applications for the vertical lift module (VLM) can be diverse.
- Tray sizes conform to store any type of product.
- Flexibility in height allows many combinations of material types.

Characteristics

- Clasimat is a quick, trustworthy, flexible system that compliments the warehouse and can be integrated into other storage systems.



- To optimize operations and have control of stored product, it is best to take advantage of the height of the warehouse.
- As this system is ideal for storing any product usually shipped in boxes: tools, electronic components, spare parts, pharmaceutical /laboratory products, cosmetics/perfumes, jewelry, textiles, etc., it simplifies order preparation.

J&D Vertical Carousels

Minimizing dependence on forklifts and ladders, J&D Vertical Carousels can save up to 70 % of valuable floor space while providing an ergonomic environment for employees.



Successful companies partner with us because of the creative solutions and unsurpassed customer focus that has become our trademark.

Services and Support

- 24/7 Technical Assistance
- National Coverage
- Flexible Invoicing
- Preventative Maintenance Programs
- Single Contact Source for Service
- Customized Reporting



- **Rolled Goods.** Stores and rotates rolled goods and textiles for easy accessibility and integration with a cutting table, cutting machine or vinyl printer.
- **Carpet / Vinyl.** With the press of a button, the Carpet / Vinyl carousel delivers the product to the desired location.
- **Tray Storage.** The best solution to your space problem, you can save over 70% of your expensive shop space.
- **Wire and Spools.** Organize your wire, cable and other spooled products and safely store/dispense wire and cable. No more lost time trying to find that reel of cable. Simply bring the roll to you with a motorized carousel.
- **Print Cylinder.** Organize, protect and manage your valuable print cylinders. It is one of the finest vertical carousels to store your print cylinders.
- **Apparel.** Designed to hold apparel, this carousel can help you to reclaim lost space. It can store over 110 linear feet of apparel in only 17-1/2 feet.



Interlake Mecalux's Retail Service Solutions provides retailers a turn-key solution to maintaining their store fixtures and equipment. The management team, call center, technicians, support staff and business operations have been in place since 1983. RSS is focused on servicing the growing retail industry in areas of retail lighting maintenance and retrofit, electromechanical repairs and maintenance, rack repair and inspections and national roll outs. RSS services all equipments, racks, shelving and lighting providing retailers nationwide service with one call.



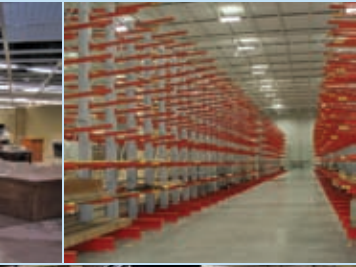

Service Center

Our customer service center provides Retail Service Solutions customers with the following benefits:

- Nationwide dispatch by dialing a single toll-free telephone number
- 7 days a week, 24-hour emergency dispatch, when needed
- Retrofit project management
- Custom invoicing
- Technical Support
- Distribution Capacity

Lighting Maintenance

Retail Service Solutions provides a complete range of lighting services including:

- Survey, design and installation of lighting fixtures
- Group relamping and lighting fixture
- Planned lighting management agreements

Electro-Mechanical Maintenance

RSS ensures that we have the best trained crews with all the equipment to get the job done correctly, safely, and at each store location.

We Service:

- Paint Mixers
- Pipe Threaders
- Blind Cutters
- Power Saws
- Motorized Vertical Carousels
- Power Equipment
- Safety Upgrades to Equipment

With a 24/7 call center and nation wide coverage, a qualified RSS technician is never out of reach.





USA CORPORATE OFFICE
1600 N. 25th Ave
Melrose Park, IL 60160
Phone (708) 344-9999
Fax (708) 343-9788

PONTIAC
701 Interlake Drive
Pontiac, IL 61764
Phone (815) 844-7191
Fax (815) 842-2327

DALLAS
1520 Selene Drive
Carrollton, TX 75006
Phone (972) 245-3910
Fax (972) 245-3920

BROWNSVILLE
6333 Padre Island Hwy, Unit 4-A
Brownsville, TX 78520
Phone (956) 831-7070
Fax (956) 831-7076

SUMTER
1925 Corporate Way
Sumter, SC 29154
Phone (803) 481-3482
Fax (803) 481-6315

SAN DIEGO
8607 Ave de la Fuente
San Diego, CA 92154
Phone (619) 671-0335
Fax (619) 671-0501

LEXINGTON
804 Newtown Circle, Suite B
Lexington, KY 40511
Phone (859) 253-0879
Fax (859) 253-4782

MIDDLETOWN
600 Hunter Lane
Middletown, PA 17057
Phone (717) 930-0647
Fax (717) 930-0648

TIJUANA
Blvd. Bellas Artes #9001
Ciudad Industrial
Tijuana, Baja California, MX 22500
Phone 011 (664) 647-2200

MATAMOROS
Las Rusias 2700
Industrial del Norte
Matamoros, Tamps, MX 87470
Phone 011 (52) 868-811-4400

TOLL FREE

1-877-MECALUX
1-877-632-2589

OFFICES WORLDWIDE

Argentina, Belgium, Brazil, Chile, Czech Republic, France,
Germany, Italy, Mexico, Poland, Portugal, Spain, United
Kingdom, USA

DISTRIBUTORS IN OVER 70 COUNTRIES

www.interlakemecalux.com
info@interlakemecalux.com

Mecalux has earned many certifications in the US and abroad.



The contents in this document refer exclusively to Mecalux products and are for informational and promotional purposes only. The information contained herein does not form the basis for warranty or guarantee. Mecalux reserves the right to modify without prior notice the data, figures, products and finishes in the catalog.